

Slide 1 - Slide 1

You will need to listen to the words in the online activity.

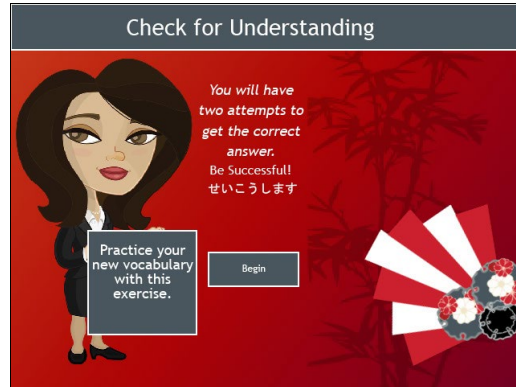

Check for Understanding

Begin

Begin

Begin

You will have two attempts to get the correct answer.

Be Successful!

せいこうします

Practice your new vocabulary with this exercise.

Unit 2: Section 1, Part A: Vocabulary - Check for Understanding (CFU) #2

Slide 2 - Slide 2

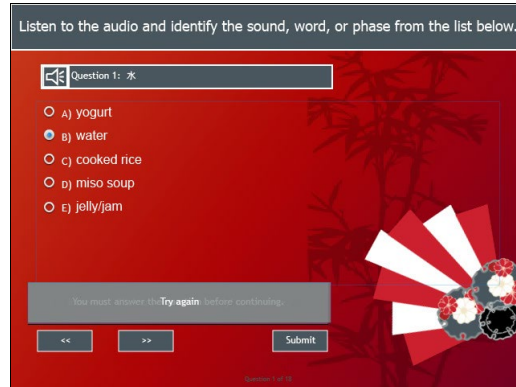

Question 1: 水

Listen to the audio and identify the sound, word, or phase from the list below.

- A) yogurt
- B) water
- C) cooked rice
- D) miso soup
- E) jelly/jam

Correct - Click anywhere or press 'y' to continue.

Incorrect - Click anywhere or press 'y' to continue.

You must answer the question before continuing.

Question 1 of 18

Try again

Unit 2: Section 1, Part A: Vocabulary - Check for Understanding (CFU) #2

Slide 3 - Slide 3

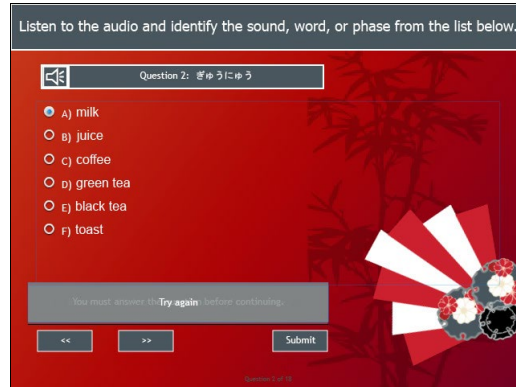

Question 2: ぎゅうにゅう

Listen to the audio and identify the sound, word, or phase from the list below.

- A) milk
- B) juice
- C) coffee
- D) green tea
- E) black tea
- F) toast

Correct - Click anywhere or press 'y' to continue.

Incorrect - Click anywhere or press 'y' to continue.

You must answer the question before continuing.

Question 2 of 18

Try again

Unit 2: Section 1, Part A: Vocabulary - Check for Understanding (CFU) #2

Slide 4 - Slide 4

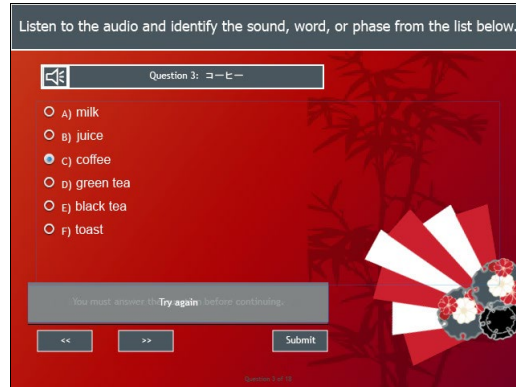

Question 3: コーヒー

Listen to the audio and identify the sound, word, or phase from the list below.

- A) milk
- B) juice
- C) coffee
- D) green tea
- E) black tea
- F) toast

Correct - Click anywhere or press 'y' to continue.

Incorrect - Click anywhere or press 'y' to continue.

You must answer the question before continuing.

Question 3 of 18

Try again

Unit 2: Section 1, Part A: Vocabulary - Check for Understanding (CFU) #2

Slide 5 - Slide 5

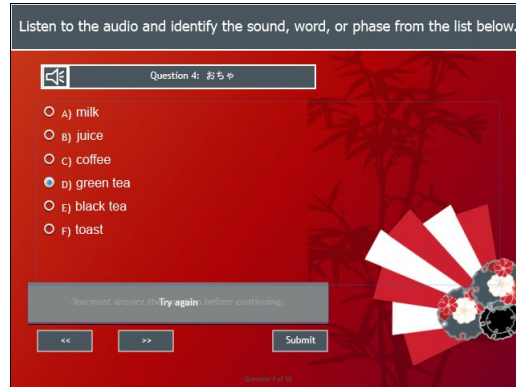

Question 4: おちゃ

Listen to the audio and identify the sound, word, or phase from the list below.

- A) milk
- B) juice
- C) coffee
- D) green tea
- E) black tea
- F) toast

Correct - Click anywhere or press 'y' to continue.

Incorrect - Click anywhere or press 'y' to continue.

You must answer the question before continuing.

Question 4 of 18

Try again

Unit 2: Section 1, Part A: Vocabulary - Check for Understanding (CFU) #2

Slide 6 - Slide 6

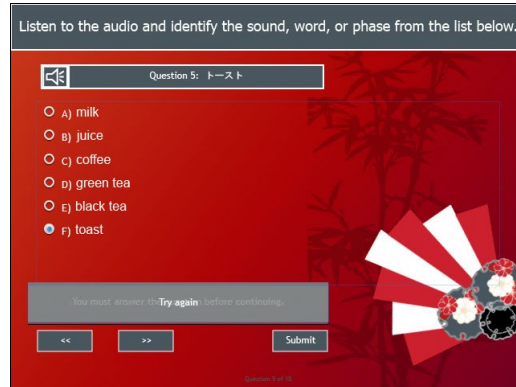

Question 5: トースト

Listen to the audio and identify the sound, word, or phase from the list below.

- A) milk
- B) juice
- C) coffee
- D) green tea
- E) black tea
- F) toast

Correct - Click anywhere or press 'y' to continue.

Incorrect - Click anywhere or press 'y' to continue.

You must answer the question before continuing.

Question 5 of 18

Try again

Unit 2: Section 1, Part A: Vocabulary - Check for Understanding (CFU) #2

Slide 7 - Slide 7

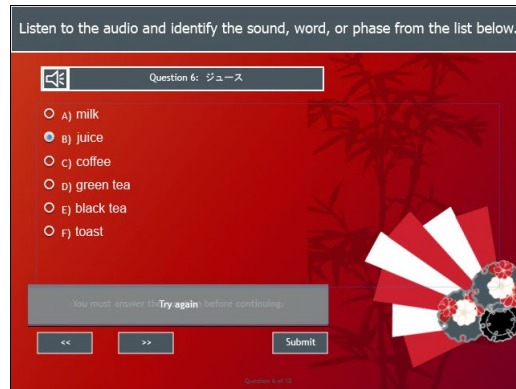

Question 6: ジュース

Listen to the audio and identify the sound, word, or phase from the list below.

- A) milk
- B) juice
- C) coffee
- D) green tea
- E) black tea
- F) toast

Correct - Click anywhere or press 'y' to continue.

Incorrect - Click anywhere or press 'y' to continue.

You must answer the question before continuing.

Question 6 of 18

Try again

Unit 2: Section 1, Part A: Vocabulary - Check for Understanding (CFU) #2

Slide 8 - Slide 8

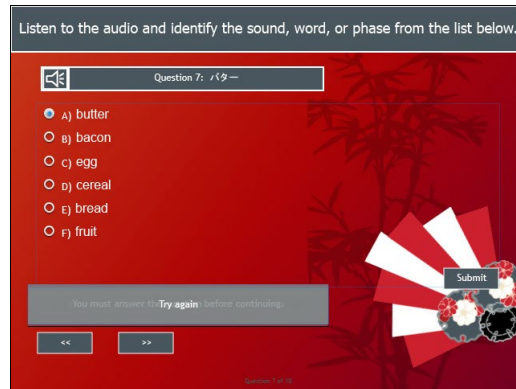

Question 7: バター

Listen to the audio and identify the sound, word, or phase from the list below.

- A) butter
- B) bacon
- C) egg
- D) cereal
- E) bread
- F) fruit

Correct - Click anywhere or press 'y' to continue.

Incorrect - Click anywhere or press 'y' to continue.

You must answer the question before continuing.

Question 7 of 18

Try again

Unit 2: Section 1, Part A: Vocabulary - Check for Understanding (CFU) #2

Slide 9 - Slide 9

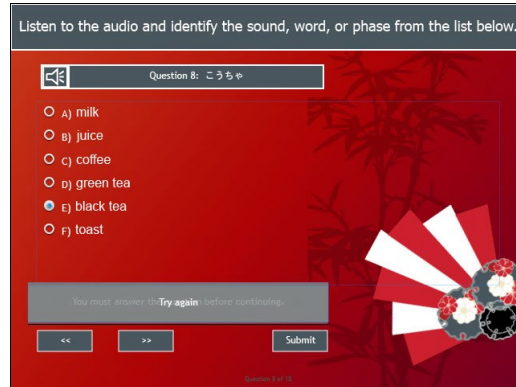

Question 8: こうちゃ

Listen to the audio and identify the sound, word, or phase from the list below.

- A) milk
- B) juice
- C) coffee
- D) green tea
- E) black tea
- F) toast

Correct - Click anywhere or press 'y' to continue.

Incorrect - Click anywhere or press 'y' to continue.

You must answer the question before continuing.

Question 8 of 18

Try again

Unit 2: Section 1, Part A: Vocabulary - Check for Understanding (CFU) #2

Slide 10 - Slide 10

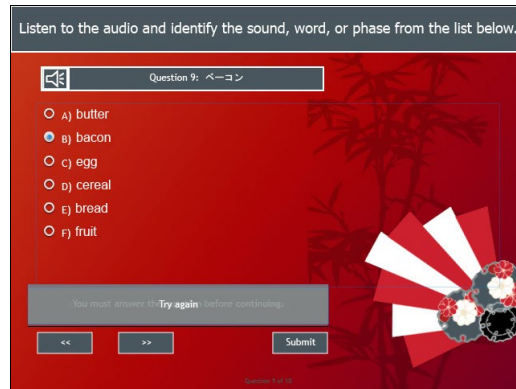

Question 9: ベーコン

Listen to the audio and identify the sound, word, or phase from the list below.

- A) butter
- B) bacon
- C) egg
- D) cereal
- E) bread
- F) fruit

Correct - Click anywhere or press 'y' to continue.

Incorrect - Click anywhere or press 'y' to continue.

You must answer the question before continuing.

Question 9 of 18

Try again

Unit 2: Section 1, Part A: Vocabulary - Check for Understanding (CFU) #2

Slide 11 - Slide 11

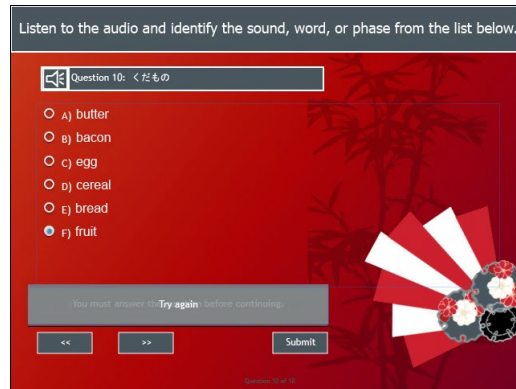

Question 10: くだもの

Listen to the audio and identify the sound, word, or phase from the list below.

- A) butter
- B) bacon
- C) egg
- D) cereal
- E) bread
- F) fruit

Correct - Click anywhere or press 'y' to continue.

Incorrect - Click anywhere or press 'y' to continue.

You must answer the question before continuing.

Question 10 of 18

Try again

Unit 2: Section 1, Part A: Vocabulary - Check for Understanding (CFU) #2

Slide 12 - Slide 12

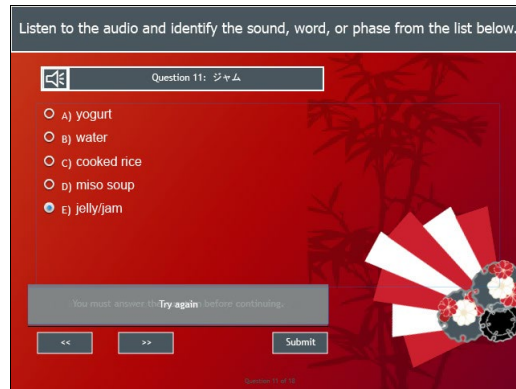

Question 11: ジャム

Listen to the audio and identify the sound, word, or phase from the list below.

- A) yogurt
- B) water
- C) cooked rice
- D) miso soup
- E) jelly/jam

Correct - Click anywhere or press 'y' to continue.

Incorrect - Click anywhere or press 'y' to continue.

You must answer the question before continuing.

Question 11 of 18

Try again

Unit 2: Section 1, Part A: Vocabulary - Check for Understanding (CFU) #2

Slide 13 - Slide 13

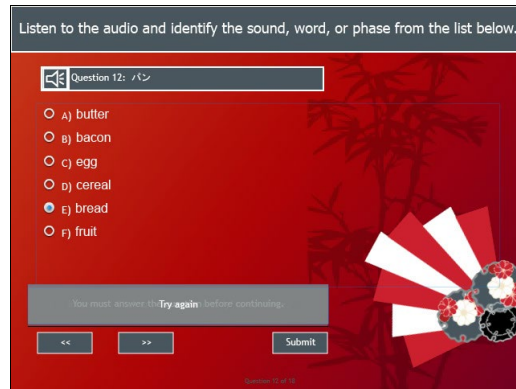

Question 12: パン

Listen to the audio and identify the sound, word, or phase from the list below.

- A) butter
- B) bacon
- C) egg
- D) cereal
- E) bread
- F) fruit

Correct - Click anywhere or press 'y' to continue.

Incorrect - Click anywhere or press 'y' to continue.

You must answer the question before continuing.

Question 12 of 18

Try again

Slide 14 - Slide 14

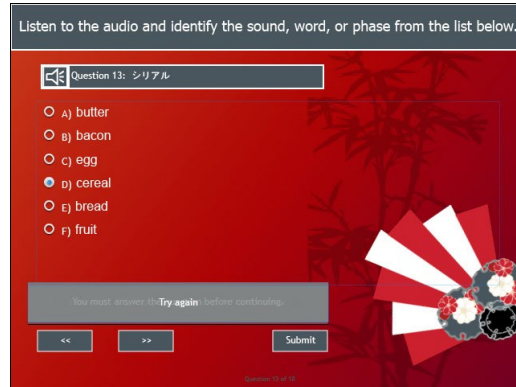

Question 13: シリアル

Listen to the audio and identify the sound, word, or phase from the list below.

- A) butter
- B) bacon
- C) egg
- D) cereal
- E) bread
- F) fruit

Correct - Click anywhere or press 'y' to continue.

Incorrect - Click anywhere or press 'y' to continue.

You must answer the question before continuing.

Question 13 of 18

Try again

Slide 15 - Slide 15

Listen to the audio and identify the sound, word, or phase from the list below.

Question 14: みそしる

- A) yogurt
- B) water
- C) cooked rice
- D) miso soup
- E) jelly/jam

You must answer this. Try again before continuing.

<< >> Submit

Question 14 of 18

Question 14: みそしる

Listen to the audio and identify the sound, word, or phase from the list below.

- A) yogurt
- B) water
- C) cooked rice
- D) miso soup
- E) jelly/jam

Correct - Click anywhere or press 'y' to continue.

Incorrect - Click anywhere or press 'y' to continue.

You must answer the question before continuing.

Question 14 of 18

Try again

Unit 2: Section 1, Part A: Vocabulary - Check for Understanding (CFU) #2

Slide 16 - Slide 16

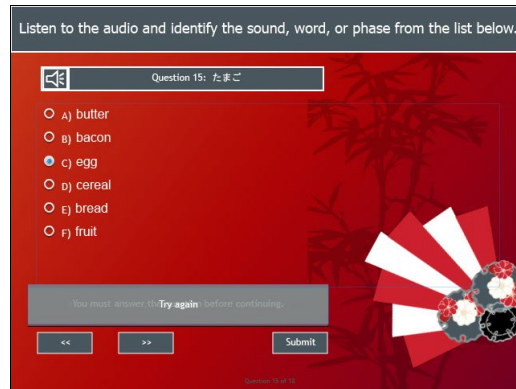

Question 15: たまご

Listen to the audio and identify the sound, word, or phase from the list below.

- A) butter
- B) bacon
- C) egg
- D) cereal
- E) bread
- F) fruit

Correct - Click anywhere or press 'y' to continue.

Incorrect - Click anywhere or press 'y' to continue.

You must answer the question before continuing.

Question 15 of 18

Try again

Unit 2: Section 1, Part A: Vocabulary - Check for Understanding (CFU) #2

Slide 17 - Slide 17

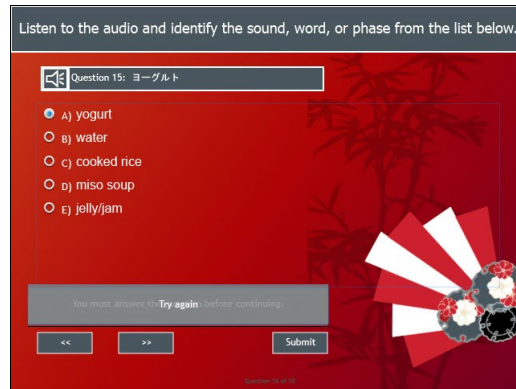

Question 15: ヨーグルト

Listen to the audio and identify the sound, word, or phase from the list below.

- A) yogurt
- B) water
- C) cooked rice
- D) miso soup
- E) jelly/jam

Correct - Click anywhere or press 'y' to continue.

Incorrect - Click anywhere or press 'y' to continue.

You must answer the question before continuing.

Question 16 of 18

Try again

Unit 2: Section 1, Part A: Vocabulary - Check for Understanding (CFU) #2

Slide 18 - Slide 18

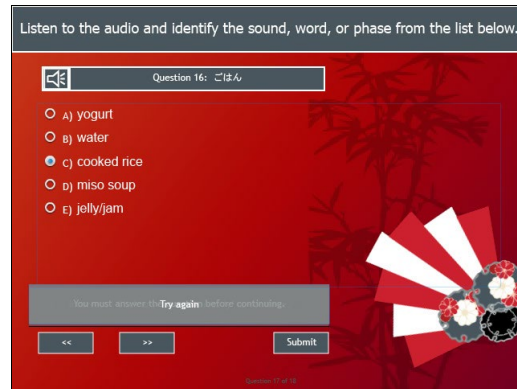

Question 16: ごはん

Listen to the audio and identify the sound, word, or phase from the list below.

- A) yogurt
- B) water
- C) cooked rice
- D) miso soup
- E) jelly/jam

Correct - Click anywhere or press 'y' to continue.

Incorrect - Click anywhere or press 'y' to continue.

You must answer the question before continuing.

Question 17 of 18

Try again

Unit 2: Section 1, Part A: Vocabulary - Check for Understanding (CFU) #2

Slide 19 - Slide 19

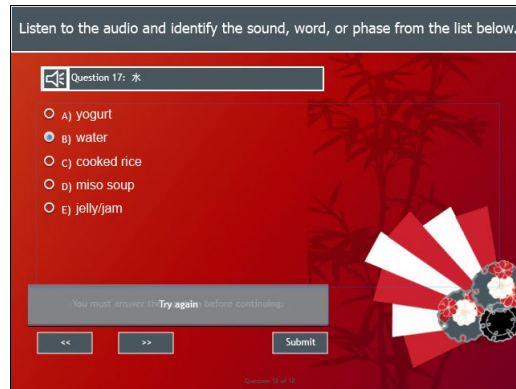

Question 17: 水

Listen to the audio and identify the sound, word, or phase from the list below.

- A) yogurt
- B) water
- C) cooked rice
- D) miso soup
- E) jelly/jam

Correct - Click anywhere or press 'y' to continue.

Incorrect - Click anywhere or press 'y' to continue.

You must answer the question before continuing.

Question 18 of 18

Try again

Unit 2: Section 1, Part A: Vocabulary - Check for Understanding (CFU) #2

Answer Key

1. B
2. A
3. C
4. D
5. F
6. B
7. A
8. E
9. B
10. F
11. F
12. E
13. D
14. D
15. C
16. A
17. C
18. B

Slide 20 - Slide 20

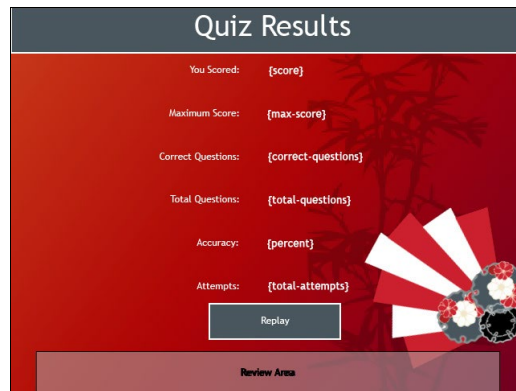

Replay

Replay

Replay

Quiz Results

You Scored:

{score}

Maximum Score:

{max-score}

Unit 2: Section 1, Part A: Vocabulary - Check for Understanding (CFU) #2

Correct Questions:

{correct-questions}

Total Questions:

{total-questions}

Accuracy:

{percent}

Attempts:

{total-attempts}